

— PROPRIETARY —
 THIS DOCUMENT CONTAINS CONFIDENTIAL, PROPRIETARY INFORMATION
 THAT IS FOR PROPERTY. DO NOT DISCLOSE TO OR DUPLICATE
 FOR OTHERS EXCEPT AS AUTHORIZED BY FOX.

REVISIONS				
ZONE	REV	DESCRIPTION	DATE	APPROVED
	A	RELEASE FOR PRODUCTION	13JUL06	
	B	CHANGED COMP CYLINDER TORQUE TO 40 IN-LB, IV BODY TORQUE TO 80 IN-LB, CORRECTED IV SHAFT PARTNAME AND P/N.	04AUG06	

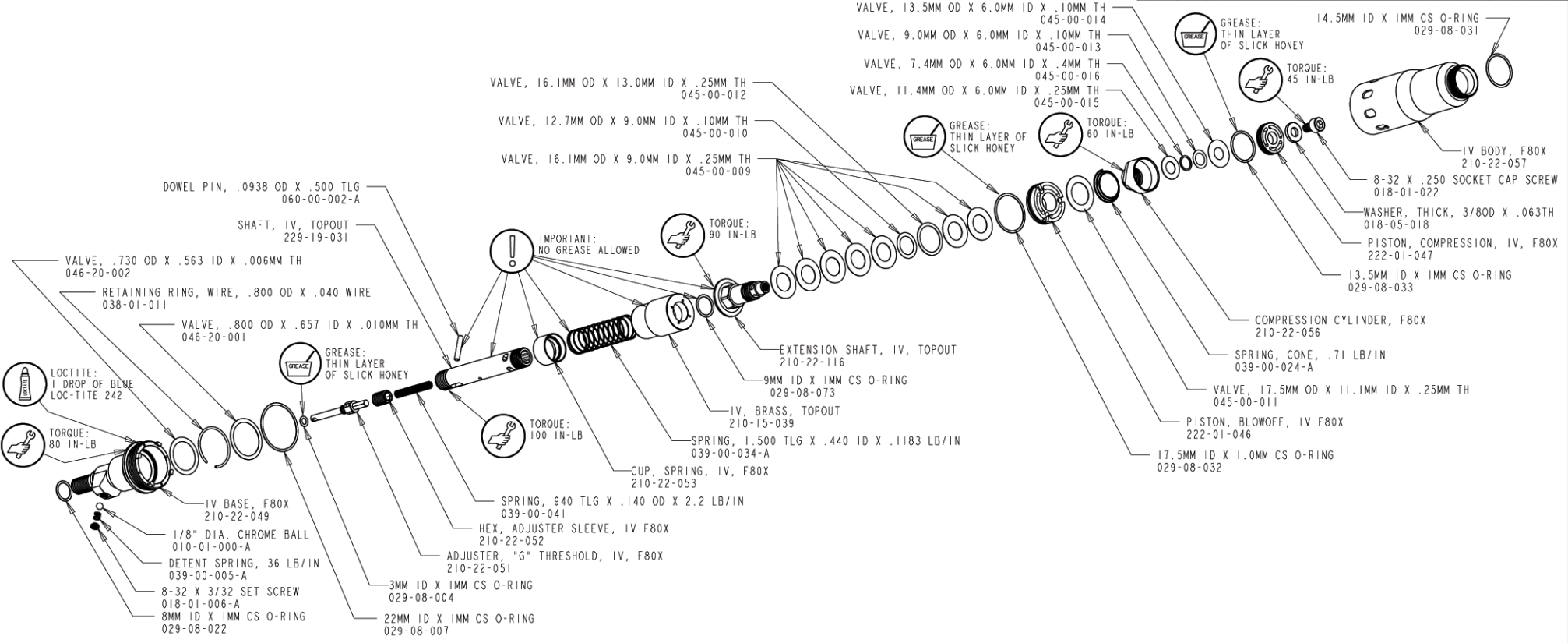

NOTE: ONLY ORDER AS A COMPLETE UNIT.
THIS ASSEMBLY IS A FACTORY BUILT UNIT.
ORDER pn 820-05-025

ITEM NO.	QTY.	PART NUMBER	DESCRIPTION	MATERIAL SPEC
UNLESS OTHERWISE SPECIFIED DIMENSIONS ARE IN INCHES [MM]			PER ASME Y14.5M 1994	
TOLERANCES ARE:			APPROVALS	DATE
DECIMALS	ANGLES		DWN. BY	B. BECKER
.XX [.X] ± .01 [0.25]	± 1°		CHK. BY	B. BECKER
.XXX [.XX] ± .005 [0.13]			ENG.	B. BECKER
THIRD ANGLE PROJECTION			MFG.	
ADD.				
FOX Factory, Inc.			130 Hangar Way, Watsonville, CA 95076 USA, Ph 831-768-1100, Fax 831-768-9312	
SUB-GROUP: IV ASSEMBLY, TOPOUT			SIZE	C
			PART NO.	820-05-023
PLOT SCALE 0.7:1			SHEET 1 OF 1	