

PROPRIETARY  
 THIS DOCUMENT CONTAINS CONFIDENTIAL, PROPRIETARY INFORMATION  
 THAT IS FOR PROPRIETARY USE ONLY. DO NOT DISCLOSE TO OR DUPLICATE  
 FOR OTHERS EXCEPT AS AUTHORIZED BY FOX.

REVISIONS				
ZONE	REV	DESCRIPTION	DATE	APPROVED
A		RELEASE FOR PRODUCTION	05MARD	

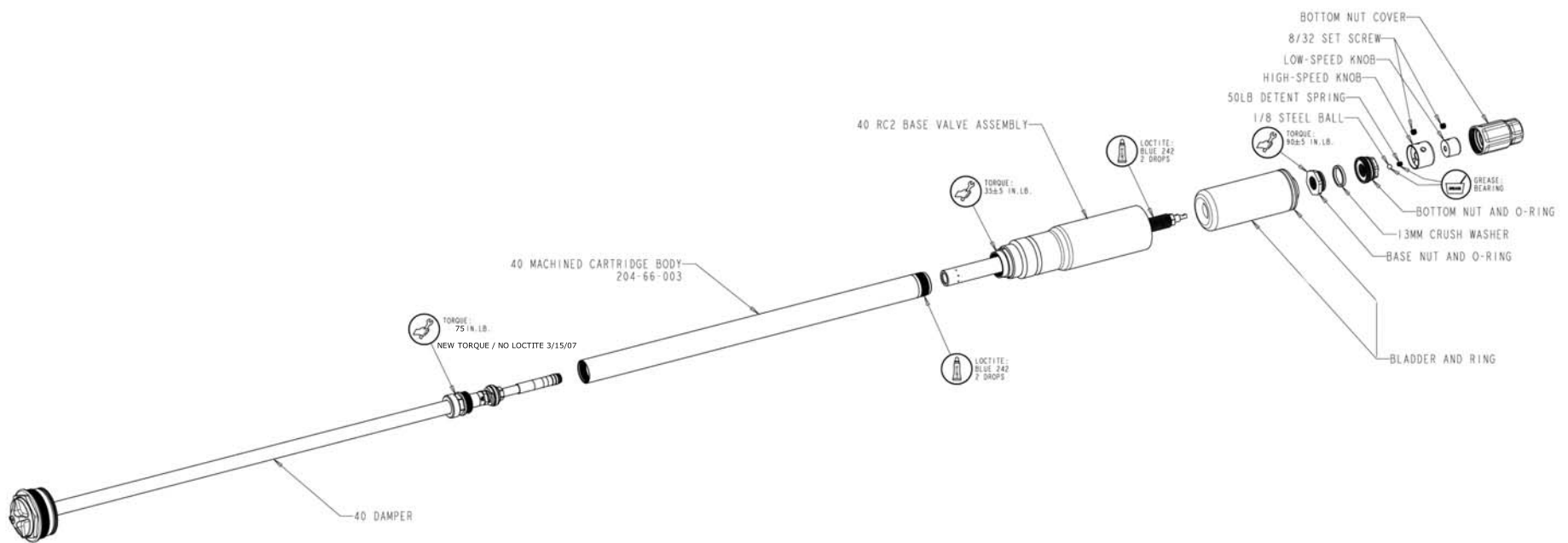

NOTE: ORDER AS FULL ASSEMBLY ONLY  
 FOR SMALL DAMPER CARTRIDGE PARTS REFER TO  
 PART LIST.

TYPE NO.		820-04-072		DESCRIPTION		MATERIAL SPEC	
QTY		PART NUMBER		PER ASME Y14.5M 1994		FOX Factory, Inc.	
UNLESS OTHERWISE SPECIFIED		DIMENSIONS ARE IN INCHES (MM)		APPROVALS		132 Hauger Way, Watsonville, CA 95076 USA, Ph 831-768-1100, Fax 831-768-9312	
TOLERANCES ARE:		ANGLES		DATE		FORK SUB-GROUP: CARTRIDGE, 2006 40 RC2	
DECIMALS		30°		DWG: B. LAMPMAN		PART NO. 820-04-072	
1/16 IN. ± 0.01 (0.25)		45°		CHK: B. LAMPMAN		SIZE D	
1/32 IN. ± 0.005 (0.13)		THIRD ANGLE PROJECTION		ENG: B. LAMPMAN		PLOT SCALE: 7:1	
DO NOT SCALE DRAWING		WFO: B. LAMPMAN		DATE		SHEET 1 OF 1	
		ZOO:					