

PROPRIETARY  
THIS DOCUMENT CONTAINS CONFIDENTIAL, PROPRIETARY INFORMATION  
THAT IS FOX PROPERTY. DO NOT DISCLOSE TO OR DUPLICATE  
FOR OTHERS EXCEPT AS AUTHORIZED BY FOX.

| REVISIONS |     |  |         |          |
|-----------|-----|--|---------|----------|
| ZONE      | REV | DESCRIPTION  | DATE    | APPROVED |
|           | A   | RELEASE FOR PRODUCTION   | 15MAR06 |          |
|           | B   | ADDED 1 DROP OF RED LOCTITE 262 TO REBOUND BOLT AND ADDED SYMBOLS. | 28JUL06 |          |

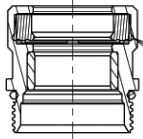

IMPORTANT:  
ORIENTATION OF SEAL WIPER LIP

SECTION A-A  
SCALE 2:1

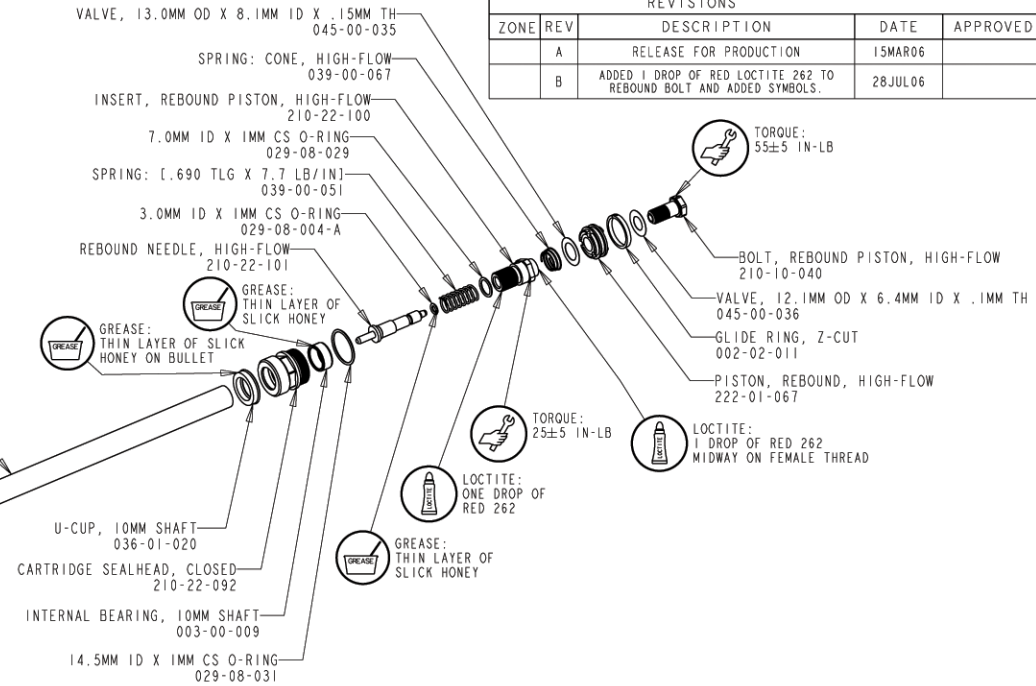
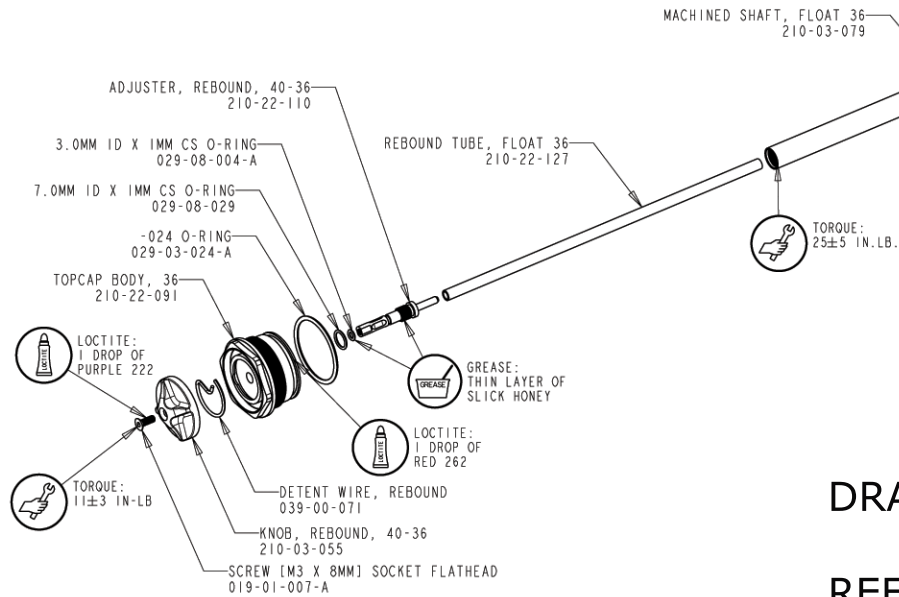

DRAWING FOR REFERENCE ONLY.  
REFER TO SMALL PARTS LIST FOR AVAILALE ITEMS.

| ITEM NO.   | QTY.   | PART NUMBER | DESCRIPTION          | MATERIAL SPEC                    |
|--|--------|-------------|----------------------|----------------------------------|
| UNLESS OTHERWISE SPECIFIED DIMENSIONS ARE IN INCHES [MM] |        |             | PER ASME Y14.5M 1994 |                                  |
| TOLERANCES ARE:  |        |             | APPROVALS            | DATE                             |
| DECIMALS   | ANGLES |             | DWN. BY              | B.LAMPMAN                        |
| .XX [I.X] ± .01 [0.25]                                   | ± 1°   |             | CHK. BY              | B.LAMPMAN                        |
| .XXX [I.XX] ± .005 [0.13]                                |        |             | ENG.                 | B.LAMPMAN                        |
| THIRD ANGLE PROJECTION                                   |        |             | DATE                 | 15MAR06                          |
| DRAWING FOR REFERENCE ONLY.                              |        |             | SHEET                | 1 OF 1                           |
| PLOT SCALE 0.6:1   |        |             | PART NO.             | 2007 36 FLOAT NON-BO DAMPER ASSY |

**FOX Factory, Inc.**  
130 Hangar Way, Watsonville, CA 95076 USA, Ph 831-768-1100, Fax 831-768-9312  
CART. SUB-GROUP:  
2007 36 FLOAT NON-BO DAMPER ASSY