

— PROPRIETARY —  
 THIS DOCUMENT CONTAINS CONFIDENTIAL, PROPRIETARY INFORMATION  
 THAT IS FOR PROPERTY. DO NOT DISCLOSE TO OR DUPLICATE  
 FOR OTHERS EXCEPT AS AUTHORIZED BY FOX.

REVISIONS				
ZONE	REV	DESCRIPTION	DATE	APPROVED
	A	RELEASE FOR PRODUCTION	09DEC05	

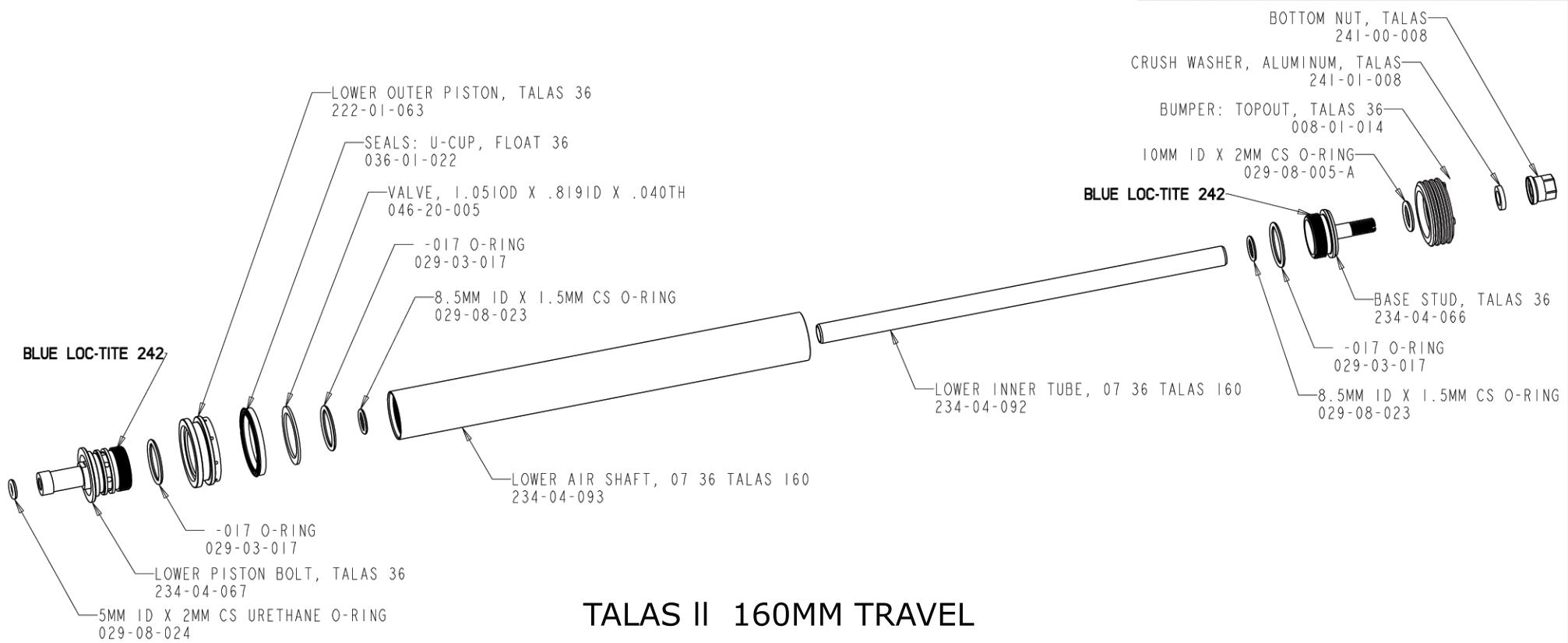

## TALAS II 160MM TRAVEL

NOTE: ORDER AS COMPLETE UNIT

REFER TO SMALL PART LIST FOR AVAILABLE  
 SMALL PARTS

ITEM NO.	QTY.	PART NUMBER	DESCRIPTION	MATERIAL SPEC
UNLESS OTHERWISE SPECIFIED DIMENSIONS ARE IN INCHES [MM]			PER ASME Y14.5M 1994	
TOLERANCES ARE:			APPROVALS	DATE
DECIMALS	ANGLES		DWN. BY	09DEC05
.XX [ .XX ] ± .01 [ 0.25 ]	± 1°		CHK. BY	09DEC05
.XXX [ .XX ] ± .005 [ 0.13 ]			ENG.	09DEC05
THIRD ANGLE PROJECTION			MFG.	
ADD.				
			SIZE	PART NO.
			C	820-02-020
			PLOT SCALE	0.75:1
			SHEET 1 OF 1	

**FOX Factory, Inc.**  
 130 Hangar Way, Watsonville, CA 94076 USA, Ph 831-768-1100, Fax 831-768-9312

SPRING SUB-GROUP:  
 07 36 TALAS 160 LOWER AIR SHAFT ASSY