

— PROPRIETARY —  
 THIS DOCUMENT CONTAINS CONFIDENTIAL, PROPRIETARY INFORMATION THAT IS FOX PROPERTY. DO NOT DISCLOSE TO OR DUPLICATE FOR OTHERS EXCEPT AS AUTHORIZED BY FOX.

REVISIONS				
ZONE	REV	DESCRIPTION	DATE	APPROVED
	A	RELEASE FOR PRODUCTION	05DEC05	

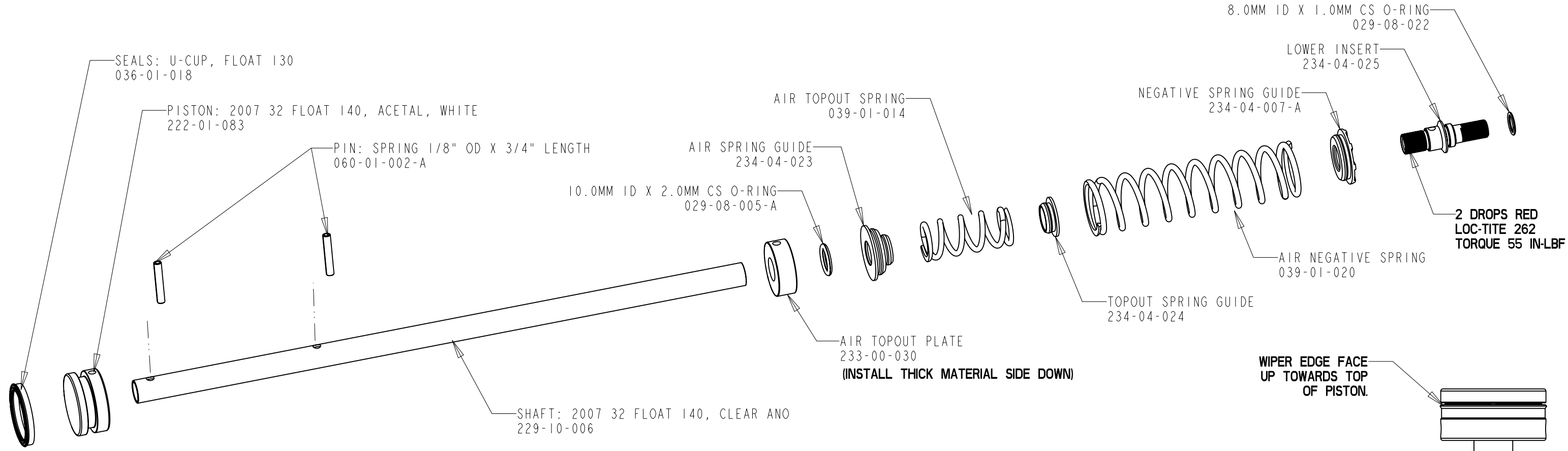

**ASSEMBLY INSTRUCTIONS:**

1. APPLY 2 DROPS OF RED LOC-TITE 262 TO THE "LOWER INSERT". THREAD THE "LOWER INSERT" INTO THE "AIR SHAFT". PUT CROSS-PIN TOOL THRU THE TOPOUT PLATE HOLE AND INSTALL THE "AIR SHAFT" INTO THE TORQUE FIXTURE WITH THE CROSS-PIN FITTING IN THE GROOVE AND THE "LOWER INSERT" FACING UP. INSTALL A CROSS-PIN TOOL IN THE "LOWER INSERT" AND TORQUE TO 55 IN-LB. WIPE AWAY EXCESS LOC-TITE.
2. INSTALL "10.0MM ID X 2.0MM CS O-RING" INTO GROOVE OF "AIR SPRING GUIDE". SNAP "AIR TOPOUT SPRING" ONTO "TOPOUT SPRING GUIDE". SNAP "AIR TOPOUT SPRING" ONTO "AIR SPRING GUIDE". SNAP "NEGATIVE SPRING GUIDE" ONTO "AIR NEGATIVE SPRING". SNAP "AIR NEGATIVE SPRING" ONTO "AIR SPRING GUIDE".
3. INSERT A BULLET TOOL ONTO THE "AIR SHAFT" AND INSTALL THE "COIL SPRING ASSEMBLY". INSTALL AND ALIGN THE LARGE HOLE ON THE "AIR TOPOUT PLATE" WITH THE LARGE HOLE ON THE ON "AIR SHAFT" AND WITH THE THICK MATERIAL SIDE TOWARDS THE INSERT. INSTALL "SPRING PIN" INTO LARGE HOLE OF "AIR TOPOUT PLATE" AND PRESS-IN WITH ARBOR PRESS TOOL. INSPECT THAT THE "SPRING PIN" IS CENTERED IN THE "TOPOUT PLATE".
4. INSTALL AND ALIGN LARGE HOLE ON "AIR PISTON" WITH THE LARGE HOLE ON THE "AIR SHAFT ASSEMBLY". INSTALL "SPRING PIN" INTO LARGE HOLE OF "AIR PISTON" AND PRESS-IN WITH ARBOR PRESS TOOL. INSPECT THAT THE "SPRING PIN" IS CENTERED IN THE "AIR PISTON". USING A GREASED BULLET TOOL, INSTALL THE "U-CUP SEAL" WITH THE CORRECT ORIENTATION ONTO THE "AIR PISTON". INSTALL THE "8MM ID X IMM CS O-RING" ONTO THE LOWER INSERT.

SCALE 1:1

ITEM NO.	QTY.	PART NUMBER	DESCRIPTION	MATERIAL SPEC
UNLESS OTHERWISE SPECIFIED DIMENSIONS ARE IN INCHES [MM]		PER ASME Y14.5M 1994		
TOLERANCES ARE:		APPROVALS	DATE	<b>FOX Factory, Inc.</b> 130 Hangar Way, Watsonville, CA 94076 USA, Ph 831-768-1100, Fax 831-768-9312 SPRING SUB-GROUP: 07 32 FLOAT 140 AIR SHAFT ASSEMBLY
DECIMALS	ANGLES	DWN. BY		
.XX [.X] ± .01 [0,25]	± 1°	B. BECKER	05DEC05	
.XXX [.XX] ± .005 [0,13]		CHK. BY		
THIRD ANGLE PROJECTION		ENG.	05DEC05	SIZE
		B. BECKER		B
DO NOT SCALE DRAWING		MFG.		PART NO.
		ADD.		820-02-028
			PLOT SCALE 1:1	SHEET 1 OF 1